

<b>AMENDMENT OF SOLICITATION/MODIFICATION OF CONTRACT</b>			1. CONTRACT ID CODE	PAGE OF PAGES 1 19
2. AMENDMENT/MODIFICATION NUMBER A002	3. EFFECTIVE DATE 03/15/2022	4. REQUISITION/PURCHASE REQUISITION NUMBER HFLCEO220072PR	5. PROJECT NUMBER (If applicable) NV FLAP US50(1)	
6. ISSUED BY FEDERAL HIGHWAY ADMINISTRATION CENTRAL FEDERAL LANDS HIGHWAY DIVISION 12300 WEST DAKOTA AVENUE, SUITE 360 LAKEWOOD, COLORADO 80228 ATTENTION: CONTRACT SPECIALIST NAME	CODE 6905001	7. ADMINISTERED BY (If other than Item 6) CODE		
8. NAME AND ADDRESS OF CONTRACTOR (Number, street, county, State and ZIP Code)		(X)	9A. AMENDMENT OF SOLICITATION NUMBER 6982AF22B000005	
		(X)	9B. DATED (SEE ITEM 11) 02/17/2022	
			10A. MODIFICATION OF CONTRACT/ORDER NUMBER	
			10B. DATED (SEE ITEM 13)	
CODE	FACILITY CODE			

**11. THIS ITEM ONLY APPLIES TO AMENDMENTS OF SOLICITATIONS**

The above numbered solicitation is amended as set forth in Item 14. The hour and date specified for receipt of Offers  is extended.  is not extended.

Offers must acknowledge receipt of this amendment prior to the hour and date specified in the solicitation or as amended, by one of the following methods:  
(a) By completing items 8 and 15, and returning \_\_\_\_\_<sup>0\*</sup> copies of the amendment; (b) By acknowledging receipt of this amendment on each copy of the offer submitted; or (c) By separate letter or electronic communication which includes a reference to the solicitation and amendment numbers. FAILURE OF YOUR ACKNOWLEDGMENT TO BE RECEIVED AT THE PLACE DESIGNATED FOR THE RECEIPT OF OFFERS PRIOR TO THE HOUR AND DATE SPECIFIED MAY RESULT IN REJECTION OF YOUR OFFER. If by virtue of this amendment you desire to change an offer already submitted, such change may be made by letter or electronic communication, provided each letter or electronic communication makes reference to the solicitation and this amendment, and is received prior to the opening hour and date specified.

12. ACCOUNTING AND APPROPRIATION DATA (If required)

**13. THIS ITEM APPLIES ONLY TO MODIFICATIONS OF CONTRACTS/ORDERS.  
IT MODIFIES THE CONTRACT/ORDER NUMBER AS DESCRIBED IN ITEM 14.**

CHECK ONE <input type="checkbox"/>	A. THIS CHANGE ORDER IS ISSUED PURSUANT TO: (Specify authority) THE CHANGES SET FORTH IN ITEM 14 ARE MADE IN THE CONTRACT ORDER NUMBER IN ITEM 10A.
<input type="checkbox"/>	B. THE ABOVE NUMBERED CONTRACT/ORDER IS MODIFIED TO REFLECT THE ADMINISTRATIVE CHANGES (such as changes in paying office, appropriation data, etc.) SET FORTH IN ITEM 14, PURSUANT TO THE AUTHORITY OF FAR 43.103(b).
<input type="checkbox"/>	C. THIS SUPPLEMENTAL AGREEMENT IS ENTERED INTO PURSUANT TO AUTHORITY OF:
<input type="checkbox"/>	D. OTHER (Specify type of modification and authority)

**E. IMPORTANT:** Contractor  is not  is required to sign this document and return     \*See Item 14     copies to the issuing office.

14. DESCRIPTION OF AMENDMENT/MODIFICATION (Organized by UCF section headings, including solicitation/contract subject matter where feasible.)

IFB

Remove and replace pages D1 thru D7, E44, and Appendix D with the attached pages D1 thru D10, E44, and Appendix D in its entirety.

PLANS

Remove and replace pages B4 and C1 with the attached corresponding pages.

\*FAILURE TO ACKNOWLEDGE THIS AMENDMENT IN BLOCK 19 OF THE SF 1442 BY THE DESIGNATED DATE AND HOUR SPECIFIED IN THE SOLICITATION MAY RESULT IN REJECTION OF YOUR BID (REFER TO ITEM 11.)

Except as provided herein, all terms and conditions of the document referenced in Item 9A or 10A, as heretofore changed, remains unchanged and in full force and effect.

15A. NAME AND TITLE OF SIGNER (Type or print)		16A. NAME AND TITLE OF CONTRACTING OFFICER (Type or print)	
15B. CONTRACTOR/OFFEROR		16B. UNITED STATES OF AMERICA	
15C. DATE SIGNED		16C. DATE SIGNED	
<hr/> (Signature of person authorized to sign)		<hr/> (Signature of Contracting Officer)	

Previous edition unusable

"General Decision Number: NV20220010 02/25/2022

Superseded General Decision Number: NV20210010

State: Nevada

Construction Type: Highway  
HIGHWAY CONSTRUCTION PROJECTS (excluding tunnels, building structures in rest area projects & railroad construction; bascule, suspension & spandrel arch bridges designed for commercial navigation, bridges involving marine construction; and other major bridges).

Counties: Douglas and Lyon Counties in Nevada.

HIGHWAY CONSTRUCTION PROJECTS (excluding tunnels, building structures in rest area projects & railroad construction; bascule, suspension & spandrel arch bridges designed for commercial navigation, bridges involving marine construction; and other major bridges).

Note: Contracts subject to the Davis-Bacon Act are generally required to pay at least the applicable minimum wage rate required under Executive Order 14026 or Executive Order 13658.

Please note that these Executive Orders apply to covered contracts entered into by the federal government that are subject to the Davis-Bacon Act itself, but do not apply to contracts subject only to the Davis-Bacon Related Acts, including those set forth at 29 CFR 5.1(a)(2)-(60).

---

|If the contract is entered |. Executive Order 14026  
|  
|into on or after January 30, | generally applies to the  
|  
|2022, or the contract is | contract.  
|

|renewed or extended (e.g., an |. The contractor must pay  
|option is exercised) on or | all covered workers at  
|after January 30, 2022: | least \$15.00 per hour (or  
| | the applicable wage rate  
| | listed on this wage  
| | determination, if it is  
| | higher) for all hours  
| | spent performing on the  
| | contract in 2022.

---

|  
|If the contract was awarded on |. Executive Order 13658  
|or between January 1, 2015 and | generally applies to the  
|January 29, 2022, and the | contract.  
|contract is not renewed or |. The contractor must pay  
all | covered workers at least  
|extended on or after January | \$11.25 per hour (or the  
|30, 2022: | applicable wage rate  
| | listed | on this wage  
| | determination, | if it is higher) for all  
| | hours spent performing on  
| | that contract in 2022.

---

The applicable Executive Order minimum wage rate will be adjusted annually. If this contract is covered by one of the Executive Orders and a classification considered necessary for performance of work on the contract does not appear on this wage determination, the contractor must still submit a conformance request.

Additional information on contractor requirements and worker protections under the Executive Orders is available at <https://www.dol.gov/agencies/whd/government-contracts>.

Modification Number	Publication Date
0	01/07/2022
1	02/18/2022
2	02/25/2022

CARP0971-001 07/01/2021

	Rates	Fringes
CARPENTER (Form Work Only) .....	\$ 33.63	18.33

-----  
-----

ELEC0401-001 01/01/2022

	Rates	Fringes
ELECTRICIAN .....	\$ 42.50	20.95

-----  
-----

ENGI0003-029 07/01/2018

	Rates	Fringes
POWER EQUIPMENT OPERATOR		
Backhoe/Excavator/Trackhoe..	\$ 38.37	24.80
Bobcat/Skid Steer/Skid		
Loader .....	\$ 35.46	24.80
Bulldozer .....	\$ 37.51	24.80

D - 4

Grader/Blade.....	\$ 38.37	24.80
Loader.....	\$ 38.18	27.79
Paver (Asphalt, Aggregate and Concrete).....	\$ 36.92	24.80
Roller.....	\$ 36.92	24.80

-----  
-----

ENGI0012-002 10/01/2016

	Rates	Fringes
POWER EQUIPMENT OPERATOR		
(6) Drill Operator.....	\$ 44.34	23.65

-----  
-----

LABO0169-004 10/01/2021

	Rates	Fringes
LABORER		
(1) Common or General; Cones/ Barricades/ Barrels- Setter/Mover/Sweeper.....	\$ 28.55	14.77
(1A) Flagger.....	\$ 25.68	14.77
(3) Asphalt Shoveler, Spreader and Distributor; Mason Tender- Cement/Concrete;.....	\$ 28.80	14.77
(4) Asphalt Raker; Pipelayer.....	\$ 29.05	14.77
(5A) Highway/Parking Lot Striping.....	\$ 31.30	14.77

-----  
-----

LABO0872-001 07/01/2020

	Rates	Fringes
LABORER		
(2) Jackhammer.....	\$ 27.96	28.79

-----  
-----

SUNV2017-009 10/01/2018

	Rates	Fringes
CEMENT MASON/CONCRETE FINISHER...\$	32.69	19.44
FENCE ERECTOR (Cyclone Chain Fence).....\$	25.18	1.61
IRONWORKER, REINFORCING.....\$	39.14	29.33
LABORER: Concrete Saw.....\$	47.05	0.00
OPERATOR: Mechanic.....\$	44.75	6.86
TRUCK DRIVER: Dump Truck.....\$	33.20	0.00

-----  
-----

WELDERS - Receive rate prescribed for craft performing operation to which welding is incidental.

=====  
=====

Note: Executive Order (EO) 13706, Establishing Paid Sick Leave for Federal Contractors applies to all contracts subject to the Davis-Bacon Act for which the contract is awarded (and any solicitation was issued) on or after January 1, 2017. If this contract is covered by the EO, the contractor must provide employees with 1 hour of paid sick leave for every 30 hours they work, up to 56 hours of paid sick leave each year. Employees must be permitted to use paid sick leave for their own illness, injury or other health-related needs, including preventive care; to assist a family member (or person who is like family to the employee) who is ill, injured, or has other health-related needs, including preventive care; or for reasons

D-6

resulting from, or to assist a family member (or person who is like family to the employee) who is a victim of, domestic violence, sexual assault, or stalking. Additional information on contractor requirements and worker protections under the EO is available at <https://www.dol.gov/agencies/whd/government-contracts>.

Unlisted classifications needed for work not included within the scope of the classifications listed may be added after award only as provided in the labor standards contract clauses (29CFR 5.5 (a) (1) (ii)).

-----  
-----

The body of each wage determination lists the classification and wage rates that have been found to be prevailing for the cited type(s) of construction in the area covered by the wage determination. The classifications are listed in alphabetical order of ""identifiers"" that indicate whether the particular rate is a union rate (current union negotiated rate for local), a survey rate (weighted average rate) or a union average rate (weighted union average rate).

#### Union Rate Identifiers

A four letter classification abbreviation identifier enclosed in dotted lines beginning with characters other than ""SU"" or

D-7

""UAVG"" denotes that the union classification and rate were prevailing for that classification in the survey. Example: PLUM0198-005 07/01/2014. PLUM is an abbreviation identifier of the union which prevailed in the survey for this classification, which in this example would be Plumbers. 0198 indicates the local union number or district council number where applicable, i.e., Plumbers Local 0198. The next number, 005 in the example, is an internal number used in processing the wage determination. 07/01/2014 is the effective date of the most current negotiated rate, which in this example is July 1, 2014.

Union prevailing wage rates are updated to reflect all rate changes in the collective bargaining agreement (CBA) governing this classification and rate.

#### Survey Rate Identifiers

Classifications listed under the ""SU"" identifier indicate that no one rate prevailed for this classification in the survey and the published rate is derived by computing a weighted average rate based on all the rates reported in the survey for that classification. As this weighted average rate includes all rates reported in the survey, it may include both union and non-union rates. Example: SULA2012-007 5/13/2014. SU indicates the rates are survey rates based on a weighted average calculation of rates and are not majority rates. LA indicates the State of Louisiana. 2012 is the year of survey on which these classifications and rates are based. The next number, 007 in the example, is an internal number used in producing the



wage determination. 5/13/2014 indicates the survey completion date for the classifications and rates under that identifier.

Survey wage rates are not updated and remain in effect until a new survey is conducted.

Union Average Rate Identifiers

Classification(s) listed under the UAVG identifier indicate that no single majority rate prevailed for those classifications; however, 100% of the data reported for the classifications was union data. EXAMPLE: UAVG-OH-0010 08/29/2014. UAVG indicates that the rate is a weighted union average rate. OH indicates the state. The next number, 0010 in the example, is an internal number used in producing the wage determination. 08/29/2014 indicates the survey completion date for the classifications and rates under that identifier.

A UAVG rate will be updated once a year, usually in January of each year, to reflect a weighted average of the current negotiated/CBA rate of the union locals from which the rate is based.

-----  
-----

WAGE DETERMINATION APPEALS PROCESS

1.) Has there been an initial decision in the matter? This can be:

\* an existing published wage determination

D-9

- \* a survey underlying a wage determination
- \* a Wage and Hour Division letter setting forth a position on a wage determination matter
- \* a conformance (additional classification and rate) ruling

On survey related matters, initial contact, including requests for summaries of surveys, should be with the Wage and Hour National Office because National Office has responsibility for the Davis-Bacon survey program. If the response from this initial contact is not satisfactory, then the process described in 2.) and 3.) should be followed.

With regard to any other matter not yet ripe for the formal process described here, initial contact should be with the Branch of Construction Wage Determinations. Write to:

Branch of Construction Wage Determinations  
Wage and Hour Division  
U.S. Department of Labor  
200 Constitution Avenue, N.W.  
Washington, DC 20210

2.) If the answer to the question in 1.) is yes, then an interested party (those affected by the action) can request review and reconsideration from the Wage and Hour Administrator

(See 29 CFR Part 1.8 and 29 CFR Part 7). Write to:

Wage and Hour Administrator  
U.S. Department of Labor  
200 Constitution Avenue, N.W.  
Washington, DC 20210

The request should be accompanied by a full statement of the interested party's position and by any information (wage payment data, project description, area practice material, etc.) that the requestor considers relevant to the issue.

3.) If the decision of the Administrator is not favorable, an interested party may appeal directly to the Administrative Review Board (formerly the Wage Appeals Board). Write to:

Administrative Review Board  
U.S. Department of Labor  
200 Constitution Avenue, N.W.  
Washington, DC 20210

4.) All decisions by the Administrative Review Board are final.

=====  
=====

END OF GENERAL DECISIO"

### Measurement

**625.11** Delete the second sentence and substitute the following:

When measuring turf establishment and supplemental applications by the acre (hectare) or square yard (square meter), measure on the ground surface.

## Section 629. — ROLLED EROSION CONTROL PRODUCTS AND CELLULAR CONFINEMENT SYSTEMS

### Construction Requirements

**629.05 (a) Slope Installations.** Delete the text and substitute the following:

**(a) Slope Installations.** At the top of the slope, anchor the RECP by using an anchor trench.

**(1) Anchor trench.** Construct a 6- by 6-inch (150- by 150-millimeter) trench. Extend the upslope terminal end of the RECP 36 inches (900 millimeters) past the trench. Use staples on 12-inch (300-millimeter) centers to fasten the RECP into the trench. Backfill the trench and compact the soil. Secure the terminal end with a single row of staples on 12-inch (300-millimeter) centers and cover the end with soil. Apply turf establishment to trench.

Securely fasten all RECP to the soil by installing staples according to the manufacturer's recommendations.

## Section 633. — PERMANENT TRAFFIC CONTROL

### Material

**633.02** Add the following:

Painting                      563

### Construction Requirements

**633.04 Sign Posts.** Add the following:

Treat all galvanized material on sign posts with a weathering agent according to Section 563.

**633.05 Sign Panels.** Add the following:

~~Treat all galvanized material on the~~ **Paint or powder coat all** ~~backs of signs~~ **brown** ~~with a weathering agent~~ according to Section 563.



Mail  
PO Box 5310  
Stateline, NV 89449-5310

Location  
128 Market Street  
Stateline, NV 89449

Contact  
Phone: 775-588-4547  
Fax: 775-588-4527  
www.trpa.org



**FINAL PERMIT**

PROJECT DESCRIPTION: Round Hill Pines Resort Intersection Improvement Project

EIP NUMBER: 03.01.02.0070

PERMITTEE(S): Federal Highway Administration, Central Federal Lands Highway Division

FILE #: EIPC2021- 0012

COUNTY/LOCATION: Douglas County/Round Hill Pines

Having made the findings required by Agency ordinances and rules, the TRPA approved the project on October 27, 2021, subject to the Standard Conditions of Approval attached hereto (Attachment Q) and the special conditions found in this permit.

This permit shall expire on October 27, 2024, unless project is diligently pursued every year. Diligent pursuit shall be defined by the condition of approval relating to completion of the project. The expiration date shall not be extended unless the project is determined by TRPA to be the subject of legal action which delayed or rendered impossible the diligent pursuit of the permit.

NO TREE REMOVAL, CONSTRUCTION OR GRADING SHALL COMMENCE UNTIL:

- (1) TRPA RECEIVES A COPY OF THIS PERMIT UPON WHICH THE PERMITTEE(S) HAS ACKNOWLEDGED RECEIPT OF THE PERMIT AND ACCEPTANCE OF THE CONTENTS OF THE PERMIT;
- (2) ALL PRE-CONSTRUCTION CONDITIONS OF APPROVAL ARE SATISFIED AS EVIDENCED BY TRPA'S ACKNOWLEDGEMENT OF THIS PERMIT;
- (3) A TRPA PRE-GRADING INSPECTION HAS BEEN CONDUCTED WITH THE PROPERTY OWNER AND/OR THE CONTRACTOR.

TRPA Executive Director/Designee

10/27/2021

Date

PERMITTEE'S ACCEPTANCE: I have read the permit and the conditions of approval and understand and accept them. I also understand that I am responsible for compliance with all the conditions of the permit and am responsible for my agents' and employees' compliance with the permit conditions. I also understand that if the property is sold, I remain liable for the permit conditions until or unless the new owner acknowledges the transfer of the permit and notifies TRPA in writing of such acceptance. I also understand that certain mitigation fees associated with this permit are non-refundable once paid to TRPA. I understand that it is my sole responsibility to obtain any and all required approvals from any other state, local or federal agencies that may have jurisdiction over this project whether or not they are listed in this permit.

Signature of Permittee(s) RYAN DANIEL MATHIS Digitally signed by RYAN DANIEL MATHIS Date: 2022.02.07 08:31:52 -07'00' Date 02/07/2022

**EIP NUMBER: 03.01.02.0070**  
**TRPA FILE NO. EIPC2021-0012**

Water Quality Mitigation Fee (1) Amount \$ \_\_\_\_\_ Paid \_\_\_\_\_ Receipt No. \_\_\_\_\_

Notes: (1) See Special Condition 3.C, below

Required plans determined to be in conformance with approval: Date: 2/11/22

TRPA ACKNOWLEDGEMENT: The permittee has complied with all pre-construction conditions of approval as of this date:

**Shannon**  
**Friedman**

Digitally signed by Shannon  
Friedman  
DN: cn=Shannon Friedman, o=Tahoe  
Regional Planning Agency, ou,  
email=sfriedman@trpa.gov, c=US  
Date: 2022.03.14 10:44:15 -07'00'

**SPECIAL CONDITIONS**

1. This permit specifically authorizes the construction of the Round Hill Pines Resort Intersection Improvement Project. The Project will relocate the existing entrance 0.2 miles north of the existing entrance and will include a left turn lane into the resort and a northbound acceleration lane along US 50. The relocated intersection will tie into a new entrance road and parking lots being constructed by the USDA Forest Service Lake Tahoe Basin Management Unit (LTBMU) in 2021. The project is within the Nevada Department of Transportation right of way and LTBMU property. It is planned for construction in 2022.
2. The Standard Conditions of Approval listed in Attachment Q shall apply to this permit.
3. Prior to permit acknowledgement, the following conditions of approval must be satisfied:
  - A. Submit one set of final construction plans electronically with the following changes:
    - I. Remove the roadway obliteration reference on sheet C01.
    - II. Include the new sign for the Round Hill Pines Resort Entrance.
    - III. Revise sheet C01 to show restoration/minimization of the existing entrance.
    - IV. Include the trees that will be removed on the plan sheets
    - V. Include revegetation on the plan sheets.
    - VI. Show restoration of section of shared use trail that is proposed to be removed. It should be restored so that it is de-compacted and allows water to naturally infiltrate and supports native vegetation.
  - B. The applicant shall mitigate the 5,314 square feet of coverage in Land Capability District 2 by proposing and implementing a restoration project(s) onsite or offsite. The restoration project shall restore land in Land Capability Districts, 1a, 1b, 1c, or 2 at 1.5 times the area of land covered for the project beyond that permitted by the coefficients in Table 30.4.1.1. The project shall be identified prior to acknowledgement of this permit.

- C. The required water quality offset for the 13,547 square feet of coverage in Land Capability Districts 4 may be mitigated one of two ways, or a combination of both per TRPA Code of Ordinances, Section 60.2.3 (Required offsets). The application may propose a water quality mitigation project or pay a water quality mitigation fee at a rate of \$1.86/sq. ft. of coverage, or a combination of the two. The mitigation plan or water quality fees shall be submitted prior to acknowledgement of this permit.
4. Prior to the pre-grade inspection, the following conditions of approval shall be satisfied:
    - A. The permittee shall submit an updated construction schedule to TRPA prior to commencement of construction. This schedule shall identify dates for the following:
      - When installation of temporary erosion control structures will occur;
      - When each stage of construction will start;
      - When construction spoils and debris will be removed;
      - When installation of all permanent erosion control structures will occur;
      - When construction will be completed;
      - The estimated date for when the final inspection by TRPA Environmental Compliance staff will take place to ensure that all conditions of project approval have been satisfied.
    - B. An EIP project sign shall be approved, fabricated and installed at approved location(s) within the project area. Applicant shall work with the TRPA graphic designer on the design and layout of the sign.
    - C. NDOT, TRPA, Forest Service Lake Tahoe Basin Management Unit, and Central Federal Lands Highway Division shall meet with Sierra Sunset Lane representatives to discuss their public safety concerns as part of the US 50 Corridor planning study.
  5. Complete traffic and safety monitoring to identify any adverse impacts to Sierra Sunset Lane. One-year post project report the findings of the traffic and safety monitoring to the TRPA board.
  6. An onsite inspection by TRPA staff is required prior to any construction or grading activity. TRPA staff shall determine if the onsite improvements required by Attachment Q (Standard Conditions of Approval) have been properly installed. No grading or construction shall commence until TRPA pre-grade conditions of approval are met.
  7. All new galvanized or reflective metal surfaces including but not limited to guardrails, traffic signal posts, light posts, utility boxes, backs of signs, and exposed culverts shall be treated so they are not shiny or be non-galvanized.
  8. Any normal construction activities creating noise in excess to the TRPA noise standards shall be considered exempt from said standards provided all such work is conducted between the hours of 8:00 A.M. and 6:30 P.M. Regular construction work outside of these hours may require noise monitoring to ensure the project will not be in violation of TRPA noise standards.
  9. The color of rock, articulated block or concrete shall blend in with the native environment and be approved by TRPA prior to placement.

10. All above ground facilities, new or currently existing, such as sign posts, the back of signs, electrical boxes, etc. shall be colored the approved TRPA color, Brown Fed. Standard 595 FS 30059 or another approved color by TRPA.
11. Grading is prohibited any time of the year during periods of precipitation and for the resulting period when the site is covered with snow, or is in a saturated, muddy, or instable conditions (pursuant to Subsection 64.2.C of the TRPA Code of Ordinances).
12. The adequacy of all required temporary BMPs, as shown on the final construction plans, shall be confirmed at the time of the TRPA pre-grading or pre-construction inspection. Any required modifications, as determined by TRPA, shall be incorporated into the project permit at that time. Adequate BMPs must be installed prior to construction, regardless of the amount or type of BMPs shown on final construction plans.
13. All material obtained from any excavation work that is not contained within foundations, retaining walls, or by other methods approved by TRPA shall be removed from the subject parcel and disposed of at a site approved by TRPA.
14. If artifacts, archaeological soils, or unusual amounts of bone or shell are uncovered during the construction activities, all work in the area will be stopped and a qualified archeologist will be immediately contacted for on-site consultation.
15. The roots of trees (adjacent to the pathway) over four inches in diameter shall not be severed, if avoidable, pursuant to Subsection 65.2F of the TRPA Code of Ordinances.
16. No trees shall be removed (other than those shown on the approved site plan) without prior TRPA written approval as per the Landscape and Revegetation Plan. During the project design refinement all opportunities shall be explored to reduce the number of trees to be cut that are greater than 14 inches diameter at breast height (dbh), especially those greater than 24" dbh in east side forest types and 30" dbh in west side forest types.
17. This approval is based on the permittee's representation that all plans and information contained in the subject application are true and correct. Should any information or representation submitted in connection with the project application be incorrect or untrue, TRPA may rescind this approval, or take other appropriate action.
18. Any modifications to the TRPA approved plans shall be submitted to TRPA for review and approval.
19. The permittee is responsible for ensuring that the project, as built, does not exceed the approved land coverage figures shown on the site plan. The approved land coverage figures shall supersede scaled drawings when discrepancies occur.
20. This site shall be winterized in accordance with the provisions of Attachment Q by October 15<sup>th</sup> of each construction season. All disturbed areas shall be stabilized with a 3-inch layer of mulch or covered with an erosion control blanket.



21. All permanent BMPs shall be maintained per an approved BMP inspection and maintenance plan.
22. Permittee shall contact TRPA for a final inspection at the conclusion of the project to verify that all conditions of the permit have been met and the project was implemented per the TRPA approved Plans.
23. All rock material (gravel, cobble, and boulders) shall be clean and thoroughly washed prior to arrival at the site to ensure that the rock is free of any silt or clay particles.
24. The discharge of petroleum products, construction waste and litter (including sawdust), or earthen materials to the surface waters of the Lake Tahoe Region is prohibited. All surplus construction waste materials shall be removed from the project site and disposed of at approved points of disposal.
25. All waste resulting from the saw-cutting of pavement shall be removed using a vacuum (or other TRPA approved method) during the cutting process or immediately thereafter. Discharge of waste material to surface drainage features is prohibited and constitutes a violation of this permit.
26. To the maximum extent allowable by law, the Permittee agrees to indemnify, defend, and hold harmless TRPA, its Governing Board, its Planning Commission, its agents, and its employees (collectively, TRPA) from and against any and all suits, losses, damages, injuries, liabilities, and claims by any person (a) for any injury (including death) or damage to person or property or (b) to set aside, attack, void, modify, amend, or annul any actions of TRPA. The foregoing indemnity obligation applies, without limitation, to any and all suits, losses, damages, injuries, liabilities, and claims by any person from any cause whatsoever arising out of or in connection with either directly or indirectly, and in whole or in part (1) the processing, conditioning, issuance, or implementation of this permit; (2) any failure to comply with all applicable laws and regulations; or (3) the design, installation, or operation of any improvements, regardless of whether the actions or omissions are alleged to be caused by TRPA or Permittee.

Included within the Permittee's indemnity obligation set forth herein, the Permittee agrees to pay all fees of TRPA's attorneys and all other costs and expenses of defenses as they are incurred, including reimbursement of TRPA as necessary for any and all costs and/or fees incurred by TRPA for actions arising directly or indirectly from issuance or implementation of this permit. Permittee shall also pay all costs, including attorneys' fees, incurred by TRPA to enforce this indemnification agreement. If any judgment is rendered against TRPA in any action subject to this indemnification, the Permittee shall, at its expense, satisfy and discharge the same.

**END OF PERMIT**

**DRAINAGE SUMMARY**

Item Number	15215-3000	20301-1400	20301-2000	20302-2100	20310-1000	NO PAY	25101-2200	60201-0500	60201-0600	60210-0500	60210-0600	60212-0600	60213-0600	60401-0000	60403-0000	60704-0000	Remarks		
Station	Side	Skew (deg)	SURVEY AND STAKING, DRAINAGE STRUCTURE	REMOVAL OF INLET	REMOVAL OF PIPE END SECTION	REMOVAL OF PIPE CULVERT	PLUG, EXISTING PIPE	GEOTEXTILE FILTER, CLASS 1, TYPE B (NON-WOVEN)	PLACED RIPRAP, METHOD B, CLASS 2	15-INCH PIPE CULVERT	18-INCH PIPE CULVERT	END SECTION FOR 15-INCH PIPE CULVERT	END SECTION FOR 18-INCH PIPE CULVERT	ELBOW, 18-INCH	BRANCH CONNECTION, 18-INCH	MANHOLE	INLET	CLEANING CULVERT IN PLACE	
			EACH	EACH	EACH	LNFT	EACH	SQYD	CUYD	LNFT	LNFT	EACH	EACH	EACH	EACH	EACH	EACH	EACH	
<b>US 50</b>																			
21+53	LT	0	1		1			14	4		34		1	2	1				Extend culvert Lt.
27+68	LT		1		1	25	1	11	3		75		1		1	1		1	Connect existing culvert to manhole
30+42	LT		1	2	1	10		9	3	12		1					1		
27+00	RT		1								70						1		As directed by CO.
											67								As directed by CO.
<b>TOTALS</b>			<b>4</b>	<b>2</b>	<b>3</b>	<b>35</b>	<b>1</b>	<b>34</b>	<b>9</b>	<b>12</b>	<b>246</b>	<b>1</b>	<b>2</b>	<b>2</b>	<b>2</b>	<b>1</b>	<b>2</b>	<b>1</b>	

**NOTE:**

1. Stain all exposed galvanized culverts and end sections according to the SCRs Subsections 602.02 and 602.03.

**SURFACING SUMMARY**

Item Number	30202-2000	40301-0100	40601-0000	41102-0000	41201-0000	Remarks
Station to Station	ROADWAY AGGREGATE, METHOD 2	ASPHALT CONCRETE PAVEMENT, TYPE 1	FOG SEAL	PRIME COAT	TACK COAT	
	TON	TON	TON	SQYD	TON	
<b>US 50</b>						
17+00 - 35+00	1114	2128	6	2080	7	
<b>Access Road</b>						
100+08 - 107+71	594	458	1	2193	1	
<b>Approach - Existing Entrance</b>						
16+34	23	23	0.05	109	0.05	
<b>TOTAL</b>						
	<b>1731</b>	<b>2610</b>	<b>7</b>	<b>4383</b>	<b>8</b>	

Values used for estimating purposes:

- Aggregate base . . . . 139 lb/ft3
- Asphalt concrete pavement . . . . 145.2 lb/ft3
- Fog seal . . . . 0.1 gal/yd2 (240.7 gal/ton)
- Tack coat . . . . 0.1 gal/yd2 (233 gal/ton)

**GRADING SUMMARY**

Station to Station	For Info Only	Pay Item 20420-0000	Pay Item 20703-2000	For Info Only
	Roadway Excavation	EMBANKMENT CONSTRUCTION	GEOGRID, STABILIZATION	Unclassified Borrow
	CUYD	CUYD	SQYD	CUYD
<b>US 50</b>				
17+00 - 35+00	1,028	10,894	3,383	
<b>Access Road</b>				
100+08 - 107+71	448	34,947		
<b>TOTALS</b>				
	<b>1,476</b>	<b>45,841</b>	<b>3,383</b>	<b>44,365</b>

**NOTE:**

1. Earthwork quantities not adjusted for shrink/swell.
2. Provide Geogrid Stabilization between stations 24+96, Lt. and 29+02, Lt.
3. Embankment quantities are based on prismatic (surface to surface) volumes.

**ASPHALT PAVEMENT MILLING SUMMARY**

Item Number	41301-0600	Remarks
Station to Station	ASPHALT PAVEMENT MILLING, 2-INCH DEPTH	
	SQYD	
<b>US 50</b>		
17+00 - 35+00	11493	
<b>TOTAL</b>		
	<b>11493</b>	

**LEAN CONCRETE SUMMARY**

Item Number	61401-0000	Remarks
Station to Station	LEAN CONCRETE BACKFILL	
	CUYD	
<b>US 50</b>		
21+30 - 31+38	310	Around Existing Water Line - See Special 614-A
<b>TOTAL</b>		
	<b>310</b>	

AMENDMENT 002 Revised 18-inch pipe culvert quantity.

**DRAINAGE, GRADING, AND SURFACING SUMMARIES**

STATE	PROJECT	SHEET NUMBER
NV	NV FLAP US50(1) ROUND HILL PINES ACCESS	C1

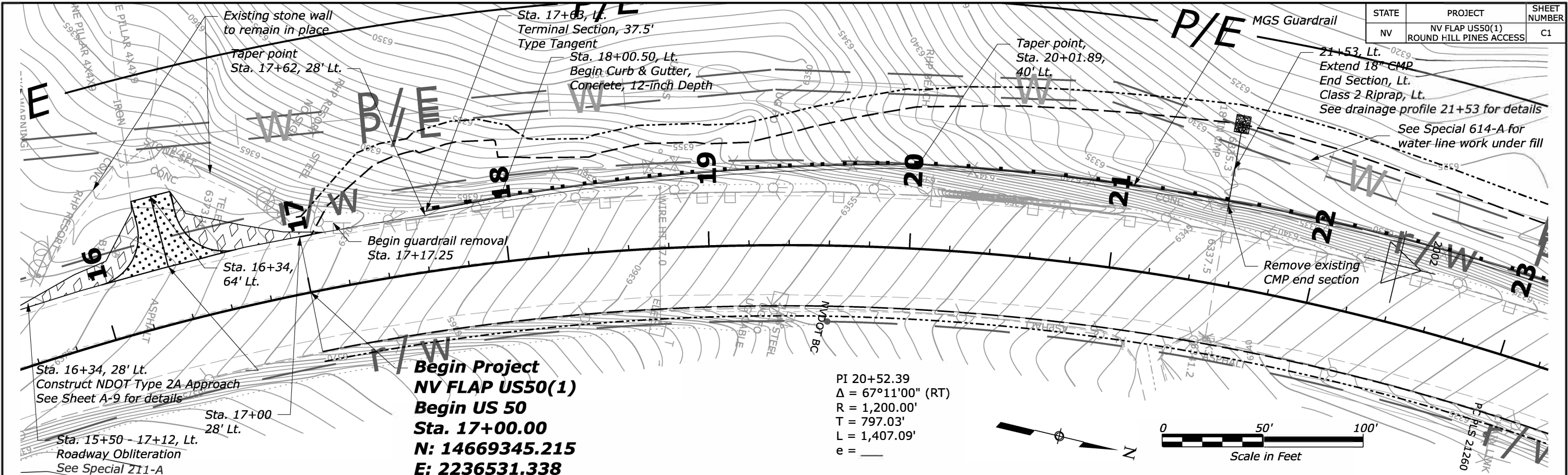

PI 20+52.39  
 $\Delta = 67^\circ 11' 00''$  (RT)  
 R = 1,200.00'  
 T = 797.03'  
 L = 1,407.09'  
 e =

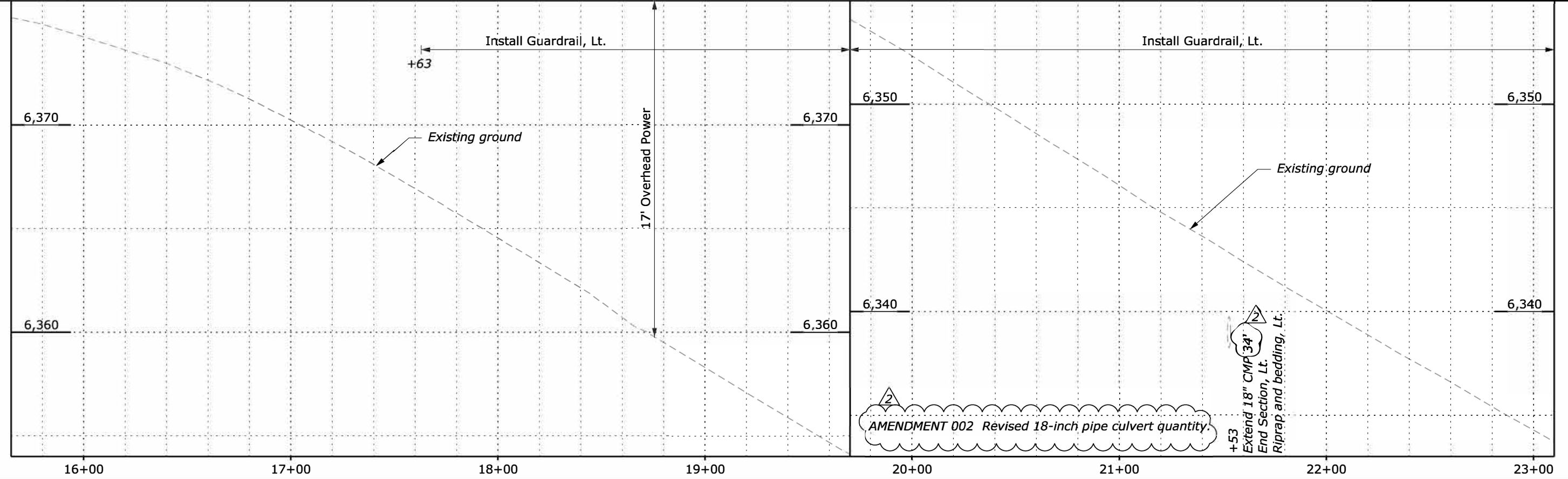
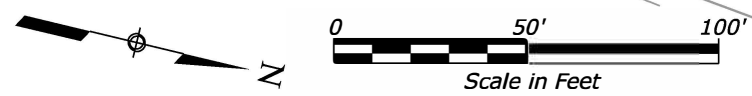

**PLAN AND PROFILE  
US 50**

C:\Adrian\CFL\FHWA\us50(1)\Roadway\CADD\_Sheets\C-ML\_P&P\C1C2C3\_PNP\_US50(1)\_01.dgn [US50 Plan 1 (Sheet)] 15 March 2022 1:17 PM